



euro
alfresco

— BY EURO APPLIANCES —



THE ART OF ALFRESCO

EMBRACE EUROPEAN QUALITY + PASSION

www.euroappliances.com.au

YOUR PRE-DESIGNED MODULAR ALFRESCO KITCHEN OPTIONS

A COMPLETE JOINERY + APPLIANCE PACKAGE DELIVERED TO YOUR DOOR*

PICCOLO
2.36
METRES

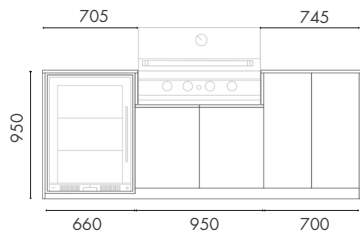

AMICI
2.66
METRES



VIVA
3.52
METRES

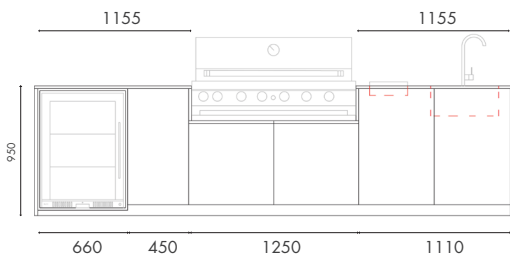

FRESCA
4.19
METRES

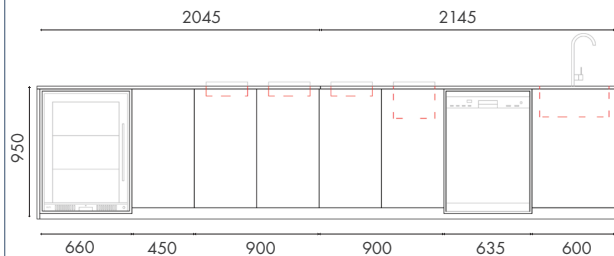

SERATA
4.79
METRES



LA MODA
5.09
METRES



*Terms and Conditions Apply

PERSONALISED MODULAR OUTDOOR ALFRESCO KITCHEN FOR YOU

Simple Steps In Embracing A Piece Of Art
That Is Your Alfresco Kitchen



— BY EURO APPLIANCES —

STEP 1

YOUR QUICK CHECKLIST GUIDE

PLAN,
MEASURE
& SELECT

We've provided you with a quick checklist guide so you know how to plan and measure your alfresco area and allocate for your service requirements.

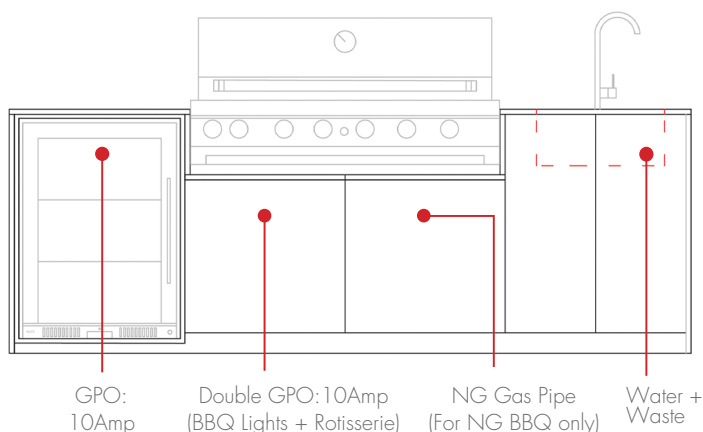

STEP 2

YOUR CHOICE OF COLOURED CABINETRY

SELECT
CABINETRY
COLOUR

Compact laminate features and on trend colour selections for kitchen doors and kickers.



Laminex®

STEP 3

YOUR CHOICE OF STONE BENCHTOPS

CHOOSE
STONE
COLOUR

Choose from our selection of quality engineered stone colours to match your cabinetry stone colours.

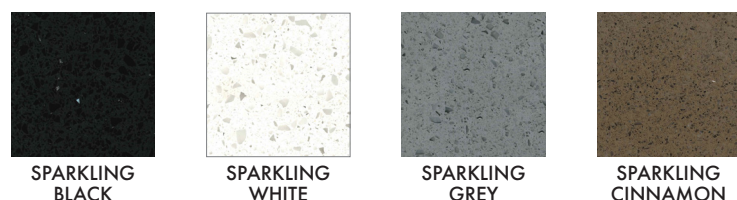

CABINETRY Laminex®



Cabinetry & Stone
Benchtops

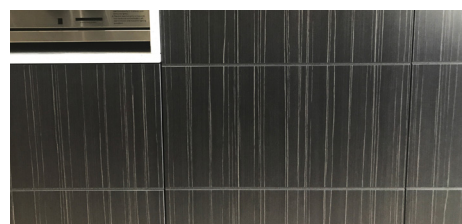

Base Carcass Units:

- + All carcass units are made from 16mm V-Lite PVC material with extreme water resistance.
- + Individually boxed including assembly instructions and joinery hardware (screws, adjustable legs, push door openers, concealed door hinges and soft close drawer runners).
- + Carcass height including adjustable legs 930mm (BBQ Unit 655mm). With 20mm space. Stone 950mm (BBQ Unit 675mm).

Doors + Drawers + Infills + Panels + Kickers:

- + All doors, drawers, infills, panels and kickers are made from 13mm Multi-purpose Compact Laminate.
- + Doors + Panels are available with or without 6mm line grooves.
- + Pre-drilled hinge holes/drawer panel mounts for easy assembly and universal left or right door selection for single door units.

STONE BENCHTOPS

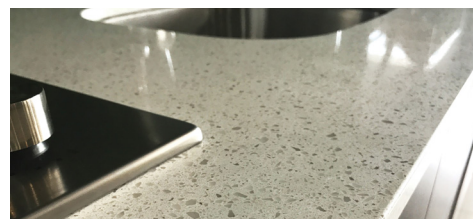

- + 20mm engineered stone bench-tops with polished edges all round for reversibility.
- + Cutouts included to suit sink, tap and dominos.
- + Option for LHS/RHS sink and fridge layouts.

STEP 4

CONFIRM
YOUR
APPLIANCES

EURO ALFRESCO APPLIANCES

Euro Appliances have a large range of specialised Alfresco Appliances. See the entire range at www.euroappliances.com.au



6 Burner BBQ Built-in
+ Flat Hood
EAL1200FBQ



6 Burner BBQ Built-in
+ Rotisserie + Roasting Hood
EAL1200FBQ



Wood Fired Pizza Oven
EPZ608BS (60 x 80)
EPZ800BS (80 x 80)



30cm Domino Electric BBQ
EMJBQ30SX



30cm Domino Deep
Fryer Cooktop
EMJFR30SX



30cm Domino Gas
Wok Cooktop
EMJG30WSX



60cm Electric Multifunction Oven
EV608SX



60cm Freestanding Dishwasher
EDS14PXS



90cm Alfresco Canopy
EBB900SS



138L Single Door Beverage Cooler
EA60WFSX2L



Undermount/Top-mount Sink
Single Bowl
EAS510UM



Pull-out Sink Mixer
EMT571 SS

STEP 5

SELECT YOUR
DELIVERY
OPTION



PICKUP



HOME
DELIVERY*



HOME
DELIVERY +
ASSEMBLY*

*Terms and Conditions Apply

euroappliances
EMBRACE EUROPEAN QUALITY + PASSION

2 Two Year
Warranty

CUSTOMER SUPPORT
TOLL-FREE **1800 440 335**



AUSTRALIAN OWNED + OPERATED

Euro Appliances and the Eurostyle Group, is an Australian owned and operated company, represented as a cultural mosaic accentuating the European flair and flavour known to all.



OUR TWO-YEAR WARRANTY

All of our appliances are covered by a two year full part and labour warranty. We attempt to ensure that each customer is treated with the utmost respect if any issues arise with any product.



PRONTO - AT YOUR SERVICE!

Our passion is being at your service. At Euro Appliances, we aim to provide a high standard of customer assistance at all times.

AKTIVO®
CLEANSERIOUSLY

WE RECOMMEND
EURO ALFRESCO
CLEANING PACK.



- + Oven + BBQ Cleaner - 750 ml
- + Fridge Cleaner + Deodoriser - 750 ml
- + Stainless Steel Cooktop Cleaner - 250 ml
- + Stainless Steel Polish - 250 ml

www.euroappliances.com.au
cooking | laundry | refrigeration | alfresco